

ZONE 21&2,22

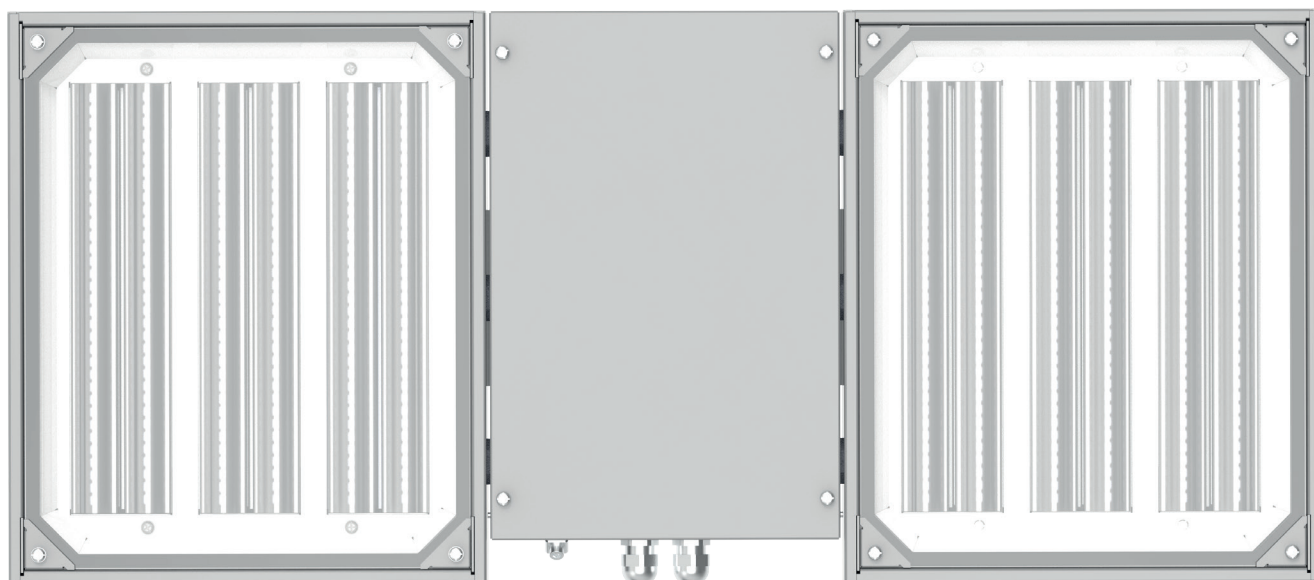

# EXL380LED



Distributed by BOXCO AB, +46 8 580 210 10  
info@boxco.se - www.boxco.se



© Copyright ATM Lighting sp. z o.o. All rights reserved.  
The company ATM Lighting sp.z o.o. reserves the right to make changes without prior notice.

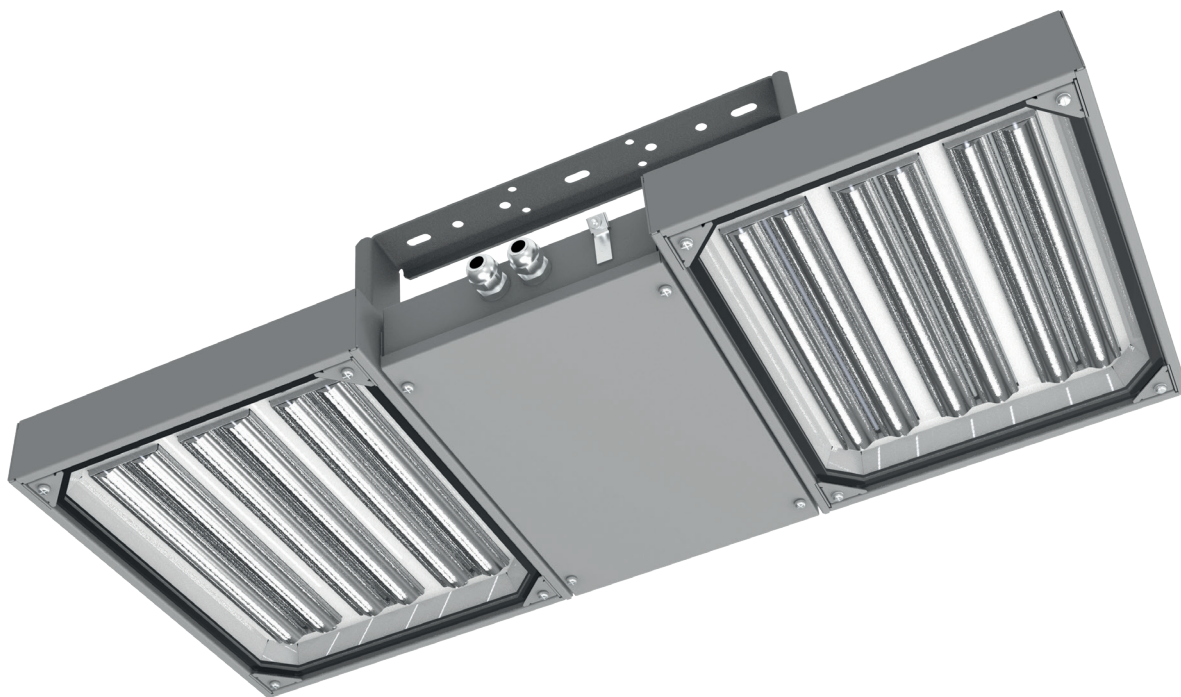

EX MARKING:



II 3G Ex ec op is IIC T4 Gc  
II 2D Ex tb op is IIIC T80°C Db

CERTIFICATES:

KDB 15ATEX0049X  
IECEX KDB 20.0003X

## EXEMPLARY APPLICATIONS



REFINERIES



OFFSHORE

CHEMICAL  
PLANTSCHEMICAL  
WAREHOUSES







DESTILLERIES

Explosionproof floodlight with **LED modules**. Designed to work in the zone **21 & 2.22** of the explosion hazard of gases, vapors and mists of flammable liquids with air, as well as of flammable dusts and fibers. The housing is made of powder coated or brushed stainless steel.







Optional version **DA** with an integrated power supply with DALI interface.

FEATURES

MECHANICAL PARAMETERS

	housing	powder coated or brushed stainless steel
	diffuser	tempered glass
	ingress protection	IP65
	protection class	I
	mounting	using accessories
	accessories	bracket

ELECTRICAL PARAMETERS

2,5 mm <sup>2</sup>		connection terminals
230V, 0/50-60 Hz		input voltage
intrinsically safe LED modules		light source
>0,97		power factor
Ø20 or Ø25		cable inlets
2 kV		overvoltage protection

WORK PARAMETERS

	ambient temperature	-40°C to +40°C <i>check: types comparison</i>
	lifetime	>70.000h L <sub>80</sub> B <sub>10</sub>

PHOTOMETRICAL PARAMETERS

>80		CRI
4000K		colour temperature

EXL380LED-045

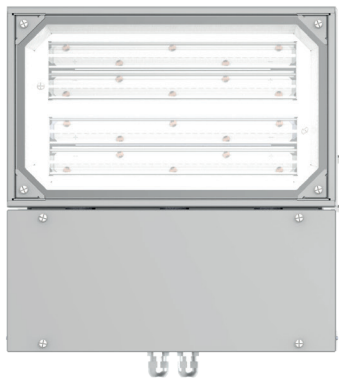

EXL380LED-090

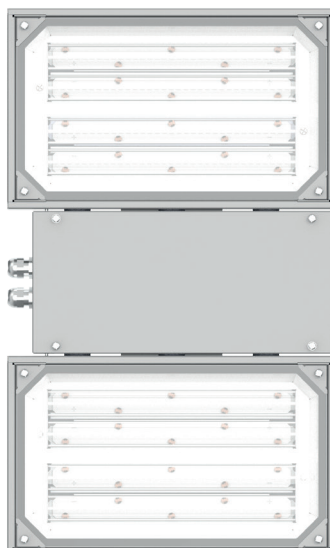

EXL380LED-130

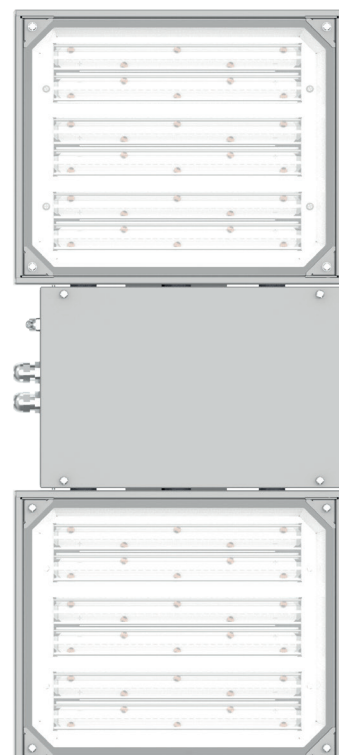

DIMENSIONS

EXL380LED-045-E4  
single version

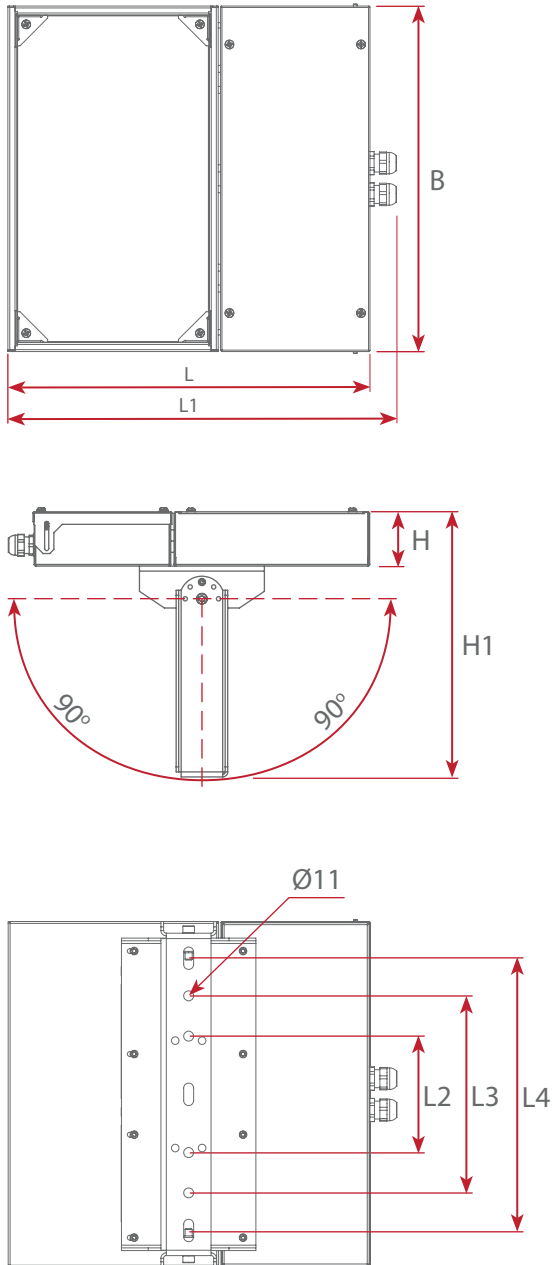

EXL380LED-090-E8, EXL380LED-130-E12  
double version

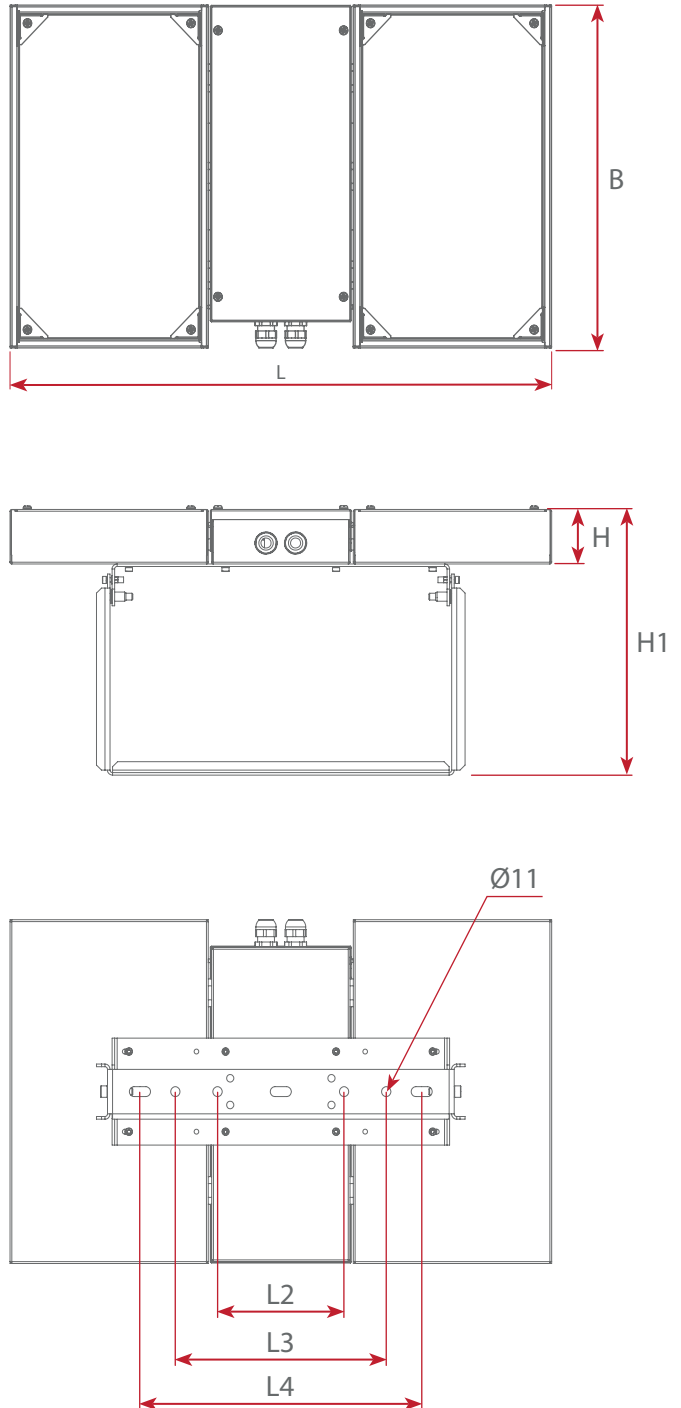

TYPE	L	L1	L2	L3	L4	B	H
EXL380LED-045-E4	405	434	130	220	290	386	69
EXL380LED-090-E8	642	-	150	250	335	386	69
EXL380LED-130-E12	885	-	150	250	335	386	69

TYPES COMPARISON

REGULAR VERSIONS

TYPE OF THE FITTING	LUMINOUS FLUX [lm]	POWER CONSUMPTION [W]	EFFICIENCY [lm/W]	AMBIENT TEMPERATURE [°C]
EXL380LED-045-E4	6 570	53	125	-40 ÷ 40
EXL380LED-090-E8	13 244	98	138	-40 ÷ 40
EXL380LED-130-E12	19 215	146	133	-40 ÷ 40

NARROW-STREAM VERSIONS

TYPE OF THE FITTING	LUMINOUS FLUX [lm]	POWER CONSUMPTION [W]	EFFICIENCY [lm/W]	AMBIENT TEMPERATURE [°C]
EXL380LED-045-E4	7 423	53	140	-40 ÷ 40
EXL380LED-090-E8	13 299	98	138	-40 ÷ 40
EXL380LED-130-E12	20 748	146	143	-40 ÷ 40



Luminous flux tolerance +/- 10%

Power tolerance +/- 10%

The parameters given in the following data sheet has been determined for the temperature Ta=25°C.

Luminous flux, light intensity distribution and efficiency has been tested on the basis of the standards EN ISO 17025:2005, norm series EN13032 and LM-79.

The actual data and General Warranty Conditions are available on our website [www.atmlighting.pl](http://www.atmlighting.pl)

OPTIONAL VERSIONS



The optional DA version is equipped with an integrated power supply with a DALI interface, which allows to monitor the operation of light fixtures and control lighting using data directly from motion sensors or from the Building Management System (BMS). A properly configured lighting control system can significantly reduce electricity costs and improve the ergonomics of users' work.

PHOTOMETRY

REGULAR VERSIONS

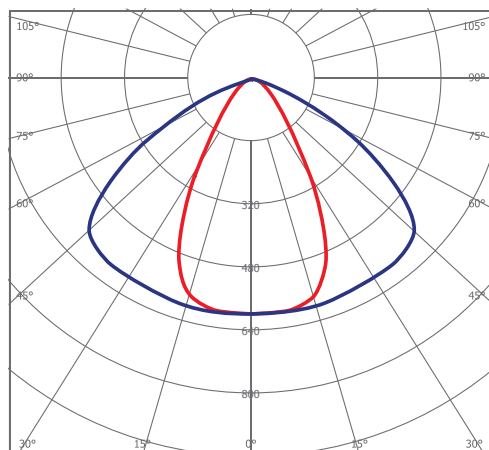

NARROW-STREAM VERSIONS

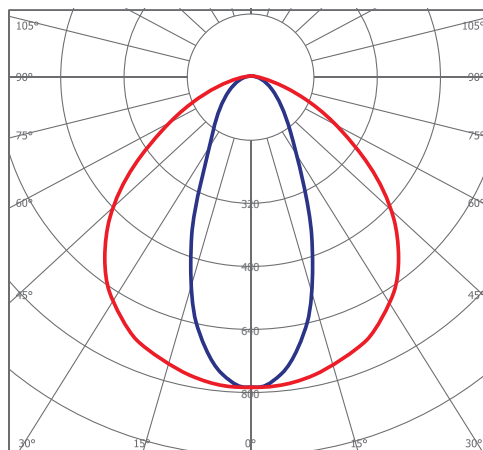

## CONFIGURATIONS

EXL380LED	-	045	-	E	-	35E	-	30	-	M	20	-	NIRO	-	GL	-	DA
<b>group</b> explosionproof light fittings		045		E		35E		30		M	20		NIRO		GL		DA
<b>type</b> type 380		090		E		35E		50		M	10		BRS		GL		DA
<b>source of light</b> LED modules		130		E		35E		70		M	11		BRS		GL		DA
<b>approximate power consumption</b> check the types comparison				E		35E				M			BRS		GL		DA
<b>LED module type</b>				E		35E				M			BRS		GL		DA
<b>LED modules quantity</b>				E		35E				M			BRS		GL		DA
<b>power supply</b> 35E - 230V, 0/50+60Hz				E		35E				M			BRS		GL		DA
<b>wiring</b> 30 - single 3-pole terminal 50 - single 5-pole terminal 70 - single 7-pole terminal				E		35E				M			BRS		GL		DA
<b>cable inlets - quantity</b> 10 - one cable inlet on the side of the housing 11 - one cable inlet on both sides of the housing				E		35E				M			BRS		GL		DA
<b>cable inlets - material</b> M - metal				E		35E				M			BRS		GL		DA
<b>cable inlets - size</b> 20 - Ø20 25 - Ø25				E		35E				M			BRS		GL		DA
<b>housing material</b> NIRO - stainless steel BRS - brushed stainless steel				E		35E				M			BRS		GL		DA
<b>diffuser material</b> GL - tempered glass				E		35E				M			BRS		GL		DA
<b>emergency versions</b> DA - version with integrated power supply with DALI interface				E		35E				M			BRS		GL		DA

## DOWNLOADS

LDT



CE