

ZONE 21&2,22

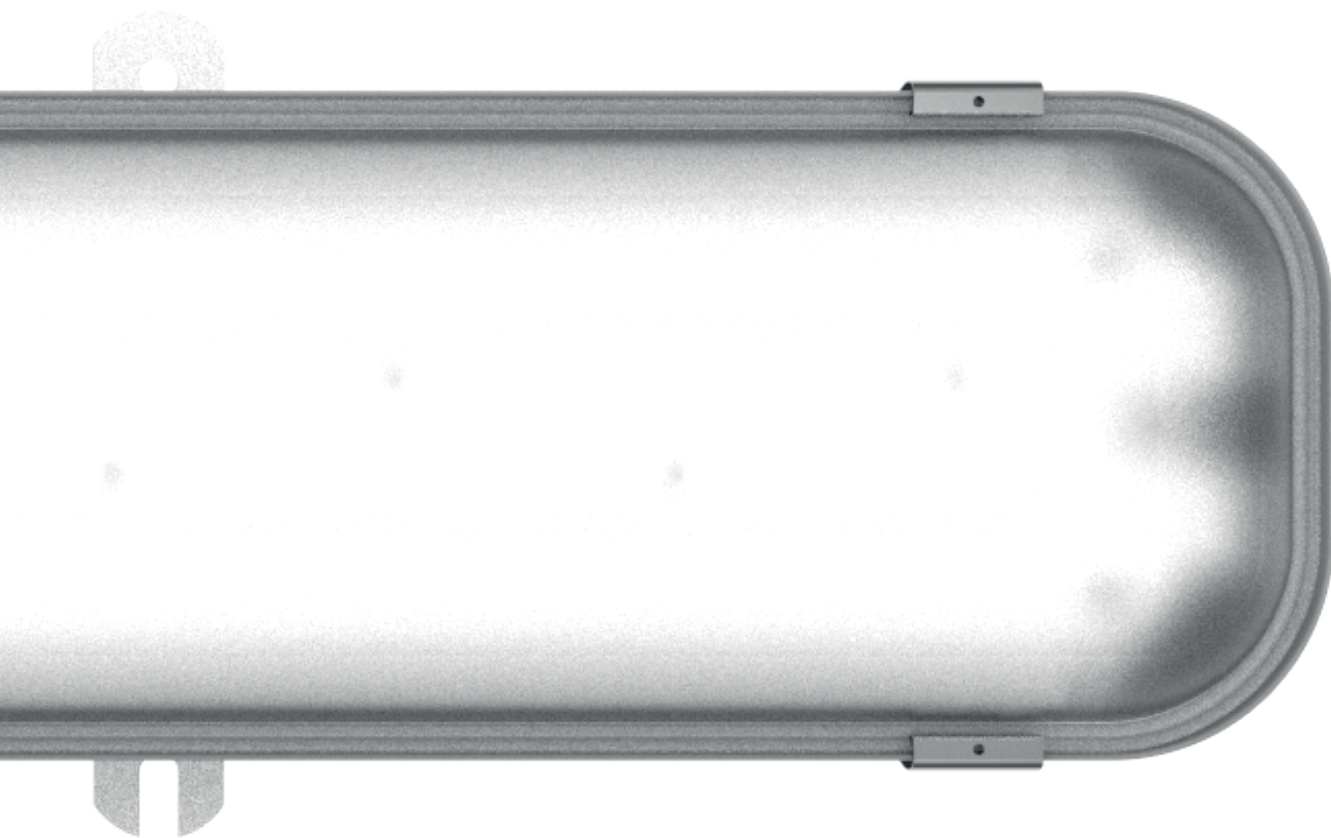

EXL210LED



Distributed by BOXCO AB, +46 8 580 210 10
info@boxco.se - www.boxco.se



© Copyright ATM Lighting sp. z o.o. All rights reserved.
The company ATM Lighting sp.z o.o. reserves the right to make changes without prior notice.



EX MARKING:

 II 3G Ex ec op is IIC T5 Gc
 II 2D Ex tb op is IIIC T60°C Db

CERTIFICATES:

ATEX:

KDB 15ATEX0049X

EN-60658-2-22:

CNBOP No. 3549/2019

HYGIENIC:

Polish NIH

EXEMPLARY APPLICATIONS

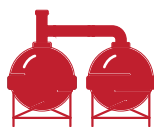

REFINERIES

FUEL
TANKSCHEMICAL
PLANTSCHEMICAL
WAREHOUSESFUEL
HANDLING
STATIONS





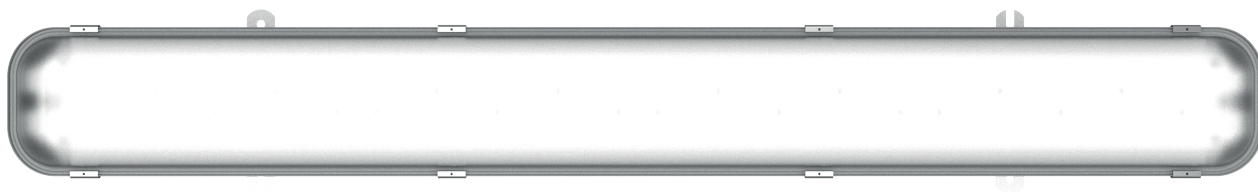

Explosionproof light fitting with **LED modules** for suspended coffered ceilings or to be mounted on the ceiling surface. Designed to work in the zone **21 & 2.22** of the explosion hazard of gases, vapors and mists of flammable liquids with air, as well as of flammable dusts and fibers. The housing is made of powder coated steel or stainless steel.

Optional version with autonomous **A3** power source, **ZB** central battery or with DALI ballast **DA**.







FEATURES





MECHANICAL PARAMETERS

	housing	fiber glass reinforced polyester (GRP)
	diffuser	UV stabilised polycarbonate
	ingress protection	IP66, IP67
	protection class	I
	mounting	on the surface with bracket
	accessories	mounting accessories

ELECTRICAL PARAMETERS

2,5 mm ²		connection terminals
230V, 0/50-60Hz		input voltage
intrinsically safe LED modules		light source
>0,97		power factor
Ø20 or Ø25		cable inlets
2 kV		overvoltage protection

WORK PARAMETERS

	ambient temperature	-40°C to +45°C <i>check: types comparsion</i>
	lifetime	>70.000h L ₈₀ B ₁₀

PHOTOMETRICAL PARAMETERS

>80		CRI
4000K		colour temperature



DIMENSIONS

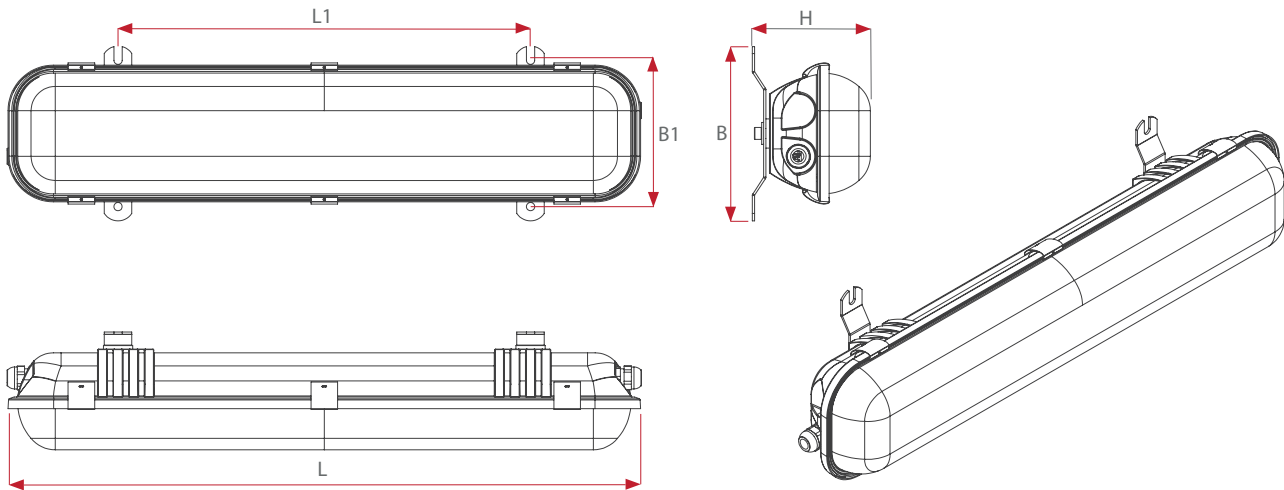

TYPE	L [mm]	L1 [mm]	B [mm]	B1 [mm]	H [mm]
EXL210LED-0600	700	450	190	160	129
EXL210LED-1200	1300	800	190	160	129
EXL210LED-1500	1600	1000	190	160	129

TYPES COMPARISON

TYPE OF THE LIGHT FITTING	LUMINOUS FLUX [lm]	POWER CONSUMPTION [W]	EFFICIENCY [lm/W]	AMB. TEMP. [°C]
EXL210LED-0600-E2	2750	16,2	170	-40 ÷ +45
EXL210LED-0600-E4	5486	31,5	174	-40 ÷ +45
EXL210LED-1200-E4	6450	38	170	-40 ÷ +45
EXL210LED-1200-E8	10925	62,2	176	-40 ÷ +45
EXL210LED-1500-E6	8207	46,9	175	-40 ÷ +45



Luminous flux tolerance +/- 10%
 Power tolerance +/- 10%
 The parameters given in the following data sheet has been determined for the temperature $T_a=25^{\circ}\text{C}$.

Luminous flux, light intensity distribution and efficiency has been tested on the basis of the standards EN ISO 17025:2005, norm series EN13032 and LM-79.

The actual data and General Warranty Conditions are available on our website www.atmlighting.pl

OPTIONAL VERSIONS



Emergency power module:
 Version with 3h emergency power module.
 The possibility of work above 0°C .

MEAN EMERGENCY MODE LUMINOUS FLUX

TYPE OF THE FITTING	VERSION A3 [lm]	VERSION ZB [lm]
EXL210LED-0600-E2	836	1375
EXL210LED-0600-E4	812	2735
EXL210LED-1200-E4	796	3225
EXL210LED-1200-E8	808	5470
EXL210LED-1500-E6	780	4103



Central battery:
 Version with a driver for central battery.

PHOTOMETRY

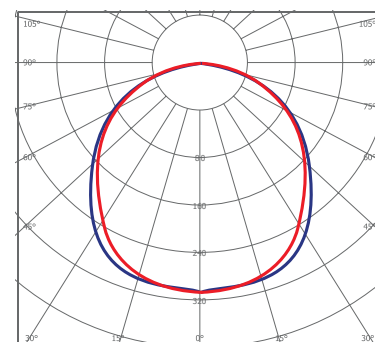

MOUNTINGS

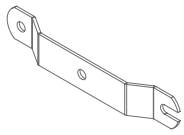

AMO1

standard mounting bracket made of 1.5mm thick steel, mounting hole spacing 190mm

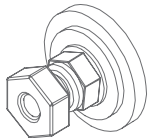
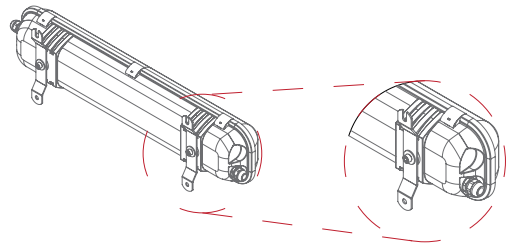

BK

standard bolt kit made to install the light fitting on the thin surfaces or the cable trays

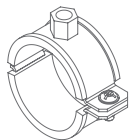
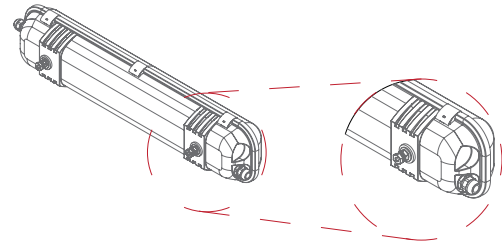

AMO3

stainless steel hoop for pipe of diameter 60-63mm

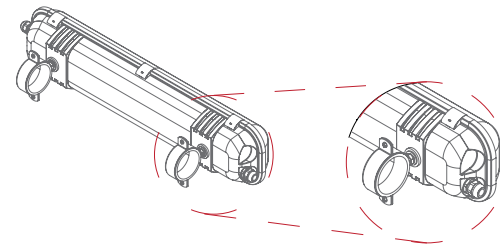

AMO4

bracket for installation at 45°

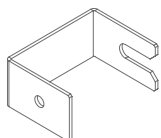
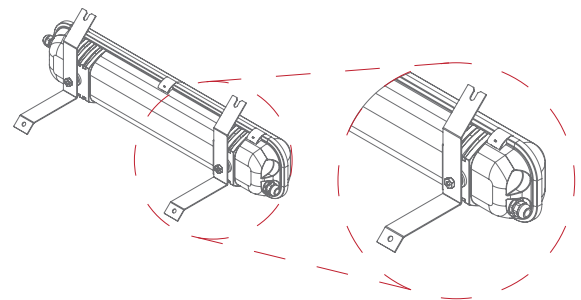

AMO5

68mm distance bracket

